

CONNECTING THE JSB-550 TO A Wi-Fi NETWORK

IMPORTANT:

- The JSB-550 only operates on a single band (2.4 GHz) Wi-Fi network. If you are having problems connecting the JSB-550 to your network, check your router settings and make sure the 2.4 GHz signal is turned and you are accessing the correct band before proceeding.
 - Before you begin, make sure you have an Amazon account. You need an Amazon account in order to use the Alexa voice control. Go to “www.Amazon.com” to register.
1. Download the JENSEN WI-FI AUDIO APP to your phone from Play store for Android phone and App store for iOS device.



Android App



iOS App

2. Turn On the unit, you will hear the voice indication for the unit in Wi-Fi mode and the Mode LED will flashing White. Press and hold the MODE button repeatedly to select Wi-Fi mode if necessary.
3. Run the JENSEN WI-FI AUDIO APP and follow on screen guide to setup the network.
4. Touch the “Add Device” button on your smartphone screen to add the first speaker to your network.

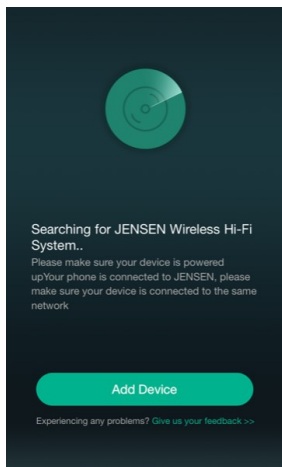

5. Go to your phone's WiFi settings page and select the Wi-Fi starting with JSB-550XXXX to connect

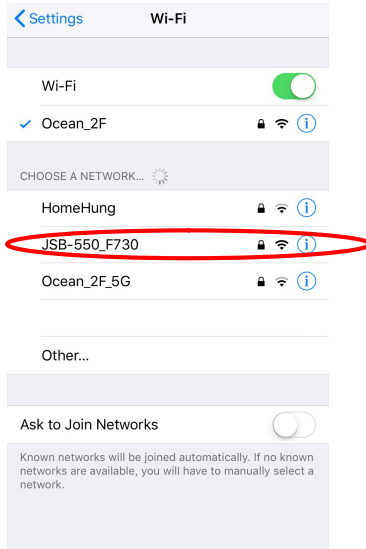
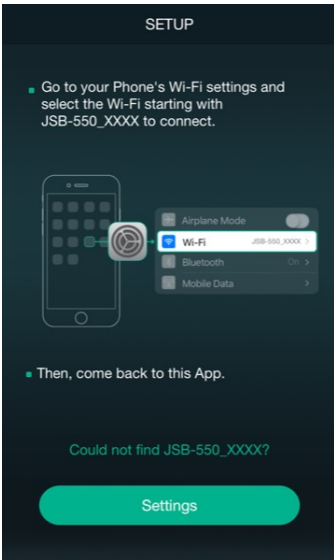

6. You may need to input the password of the speaker, input "JENSENJSB-550" if need, after that your phone would link up with the speaker.

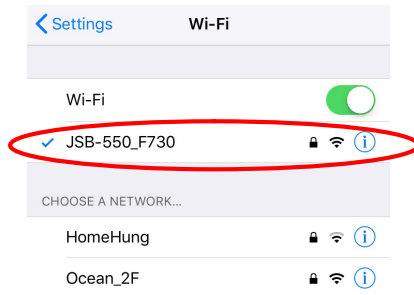
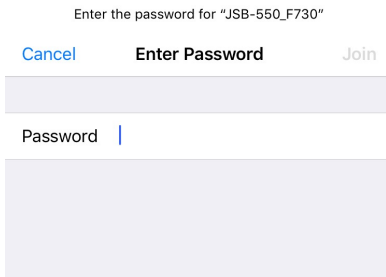

7. Go back to Jensen Apps, select your Wi-Fi network from the list and type the password of your Wi-Fi network when prompted, then touch the "Continue" button.

The Speaker would connect with your WiFi network now, touch "Next" to go ahead.

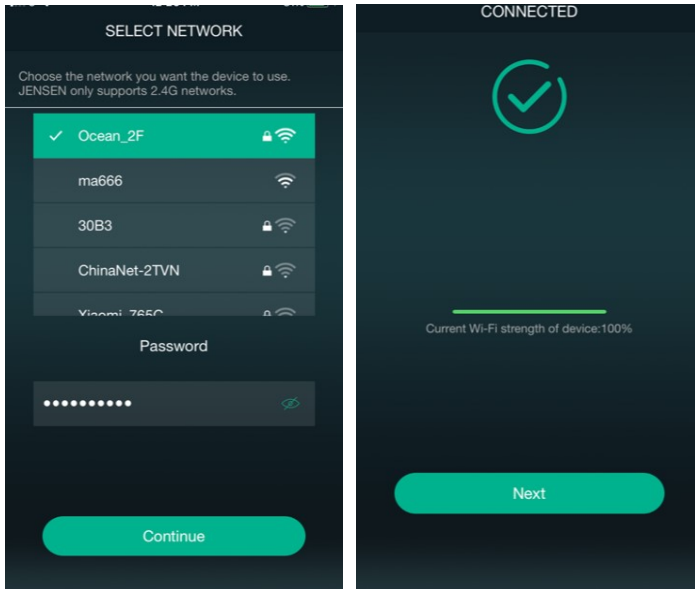

8. After the JSB-550 is connected to Wi-Fi, touch the "Next" button to select the speaker's name from the list or set a custom one.

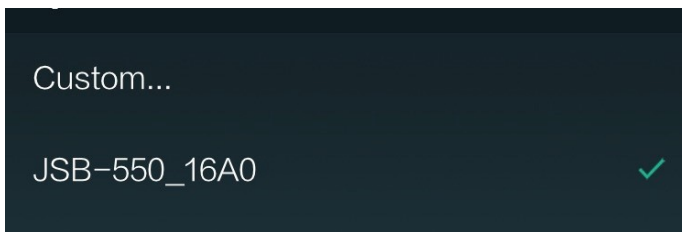

9. Sign in your Amazon account and set the Amazon language. Once you finish, you can enjoy the JSB-550 using the Alexa voice control features.

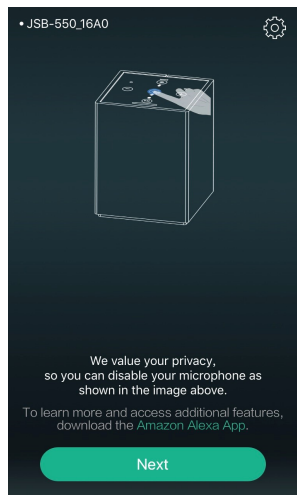
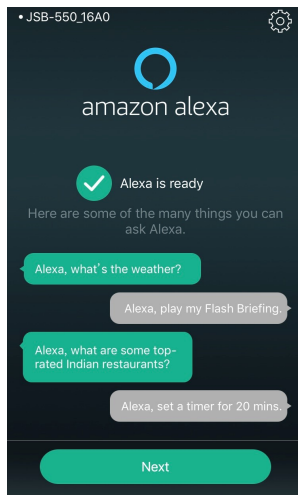
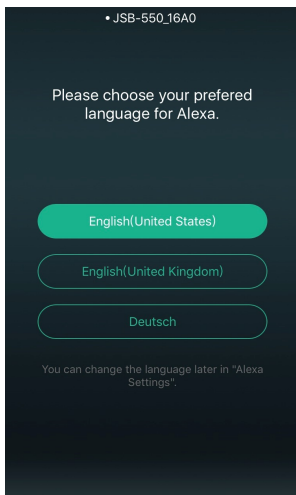
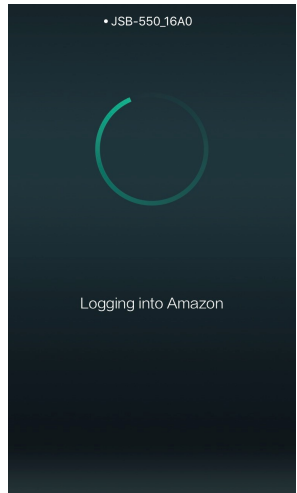
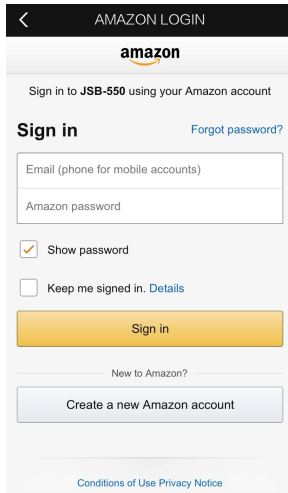
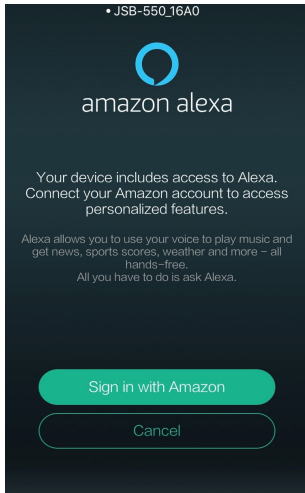

Notes:

To play music with Alexa, you also need to register the Amazon Prime Music service or upload the music on Amazon sever library.

10. To add more speakers, touch the “ + ” icon in the top right corner of your smartphone screen and repeat the above steps.

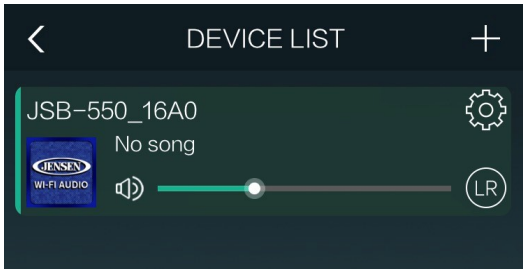

Resetting the JSB-550 Wi-Fi to Factory data reset

1. Turn on the unit and select Wi-Fi mode. Press and hold the WPS button for 5 – 6 seconds and release the button. You will hear “Factory data reset” from the speaker.
2. Wait for unit to restart , then unplug and replug the power and unit would restart again, you will hear the voice prompt for ready to set up.
3. Follow steps 3-8 above.

Note:

Always set-up the Wi-Fi connection with the JSB-550 ON and in WI-Fi mode.

Do not press the WPS button unless you are instructed to during one of the steps above. This may cause WiFi setup error.

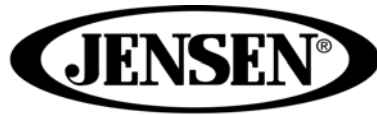

**AMAZON ALEXA ENABLED BLUETOOTH/WI-FI
WIRELESS STEREO SMART SPEAKER**

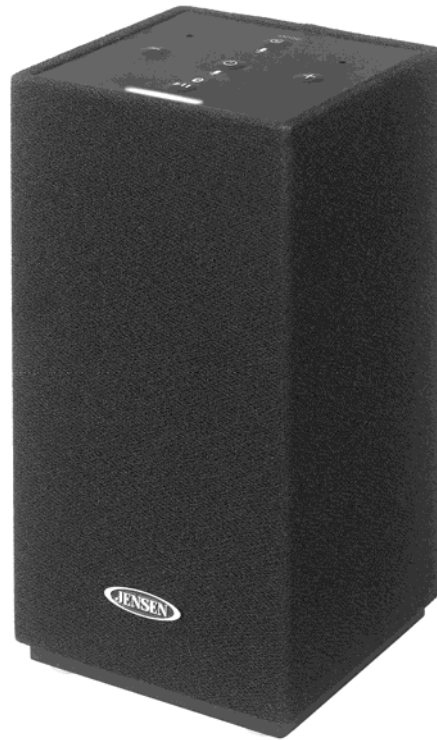

**MODEL: JSB-550
USER MANUAL**



**PLEASE READ THIS USER MANUAL COMPLETELY BEFORE OPERATING THIS
UNIT AND RETAIN THIS BOOKLET FOR FUTURE REFERENCE.**

IMPORTANT SAFETY INSTRUCTIONS

When used in the directed manner, this unit has been designed and manufactured to ensure your personal safety. However, improper use can result in potential electrical shock or fire hazards. Please read all safety and operating instructions carefully before installation and use, and keep these instructions handy for future reference. Take special note of all warnings listed in these instructions and on the unit.

1. Read these instructions – All the safety and operating instructions should be read before the appliance is operated.
2. Keep these instructions – The safety and operating instructions should be kept for future reference.
3. Heed all warnings – All warnings on the appliance and in the operating instructions should be adhered to.
4. Follow all instructions – All operation and use instructions should be followed.
5. Do not use this apparatus near water – The appliance should not be used near water; for example, near a bath tub, washbowl, kitchen sink, laundry tub, in a wet basement, or near a swimming pool.
6. Clean only with dry cloth – The appliance should be cleaned only as recommended by the manufacturer.
7. Do not block any ventilation openings. Install in accordance with the manufacturer's instructions. The appliance should be situated so that its location or position does not interfere with its proper ventilation. For example, the appliance should not be situated on a bed, sofa, rug, or similar surface that may block the ventilation openings; or placed in a built-in installation, such as a bookcase or cabinet that may impede the flow of air through the ventilation openings.
8. Do not install near any heat sources such as radiators, heat registers, stoves, or other apparatus (including amplifiers) that produce heat.
9. AC adaptor is used as disconnect device and it should remain readily operable during intended use. In order to disconnect the apparatus from the mains completely, the AC adaptor should be disconnected from the mains socket outlet completely.
10. Only use attachments / accessories specified by the manufacturer.
11. Use only with a cart, stand, tripod, bracket, or table specified by the manufacturer, or sold with the apparatus. When a cart is used, use caution when moving the cart/apparatus combination to avoid injury from tip-over.
12. Unplug this apparatus during lightning storms or when unused for long periods of time.
13. Refer all servicing to qualified service personnel. Servicing is required when the apparatus has been damaged in any way, such as power-supply cord or plug is damaged, liquid has been spilled or objects have fallen into the apparatus, the apparatus has been exposed to rain or moisture, does not operate normally, or has been dropped.
14. This appliance shall not be exposed to dripping or splashing water and that no object filled with liquids such as vases shall be placed on the apparatus.
15. Power Sources – The appliance should be connected to a power supply only of the type described in the operating instructions or as marked on the appliance. Do not overload wall outlet.
16. Do not attempt to dismantle, open or repair this product yourself. If a fault occurs, seek advice from your local qualified service technician or contact the distributor via the telephone number at the back of this instruction manual.
17. Nameplate is located on the bottom of product.



IMPORTANT NOTES

Avoid installing the unit in locations described below:

- Places exposed to direct sunlight or close to heat radiating appliances such as electric heaters.
- Places subject to constant vibration.
- Dusty, humid or moist places.
- Sources of electrical noise such as fluorescent lamps or motors.
- In case of malfunction due to electrostatic discharge, the apparatus has to be reset by disconnecting it from mains supply, wait at least for 60 seconds before reconnect

COMPLIANCE WITH FCC REGULATIONS

FCC ID :LMZ-31324GC

This device complies with Part 15 of the FCC Rules. Operation is subject to the following two conditions:

- 1) this device may not cause harmful interference, and
- 2) this device must accept any interference received, including interference that may cause undesired operation.

NOTE: This equipment has been tested and found to comply with the limits for a Class B digital device, pursuant to Part 15 of the FCC Rules. These limits are designed to provide reasonable protection against harmful interference in a residential installation. This equipment generates, uses and can radiate radio frequency energy and, if not installed and used in accordance with the instructions, may cause harmful interference to radio communications. However, there is no guarantee that interference will not occur in a particular installation. If this equipment does cause harmful interference to radio or television reception, which can be determined by turning the equipment off and on, the user is encouraged to try to correct the interference by one or more of the following measures:

- Reorient or relocate the receiving antenna.
- Increase the separation between the equipment and receiver.
- Connect the equipment into an outlet on a circuit different from that to which the receiver is connected.
- Consult the dealer or an experienced radio/TV technician for help.

CAUTION: Changes or modifications not expressly approved by the party responsible for compliance could void the user's authority to operate the equipment.

PROTECT YOUR FURNITURE

This product is equipped with non-skid rubber 'feet' to prevent the product from moving when you operate the controls. These 'feet' are made from non-migrating rubber material specially formulated to avoid leaving any marks or stains on your furniture. However certain types of oil based furniture polishes, wood preservatives, or cleaning sprays may cause the rubber 'feet' to soften, and leave marks or a rubber residue on the furniture. To prevent any damage to your furniture we strongly recommend that you purchase small self-adhesive felt pads, available at hardware stores and home improvement centers everywhere, and apply these pads to the bottom of the rubber 'feet' before you place the product on fine wooden furniture.

DEAR JENSEN® CUSTOMER

Selecting fine audio equipment such as the unit you've just purchased is only the start of your musical enjoyment. Now it's time to consider how you can maximize the fun and excitement your equipment offers. This manufacturer and the Electronic Industries Association's Consumer Electronics Group want you to get the most out of your equipment by playing it at a safe level. One that lets the sound come through loud and clear without annoying blaring or distortion and, most importantly, without affecting your sensitive hearing.

Sound can be deceiving. Over time your hearing "comfort level" adapts to higher volumes of sound. So what sounds "normal" can actually be loud and harmful to your hearing. Guard against this by setting your equipment at a safe level BEFORE your hearing adapts.

To establish a safe level:

- Start your volume control at a low setting.
- Slowly increase the sound until you can hear it comfortably and clearly, and without distortion.

Once you have established a comfortable sound level:

- Set the dial and leave it there.

Taking a minute to do this now will help to prevent hearing damage or loss in the future. After all, we want you listening for a lifetime.

We Want You Listening For a Lifetime

Used wisely, your new sound equipment will provide a lifetime of fun and enjoyment. Since hearing damage from loud noise is often undetectable until it is too late, this manufacturer and the Electronic Industries Association's Consumer Electronics Group recommend you avoid prolonged exposure to excessive noise.

Customer's Record:

The serial number of this product is found on its back cover. You should note the serial number of this unit in the space provided as a permanent record of your purchase to aid in identification in the event of theft or loss.

Model Number: JSB-550

Serial Number: _____

ACCESSORIES

- 1 x AC Adaptor
- 1 x Stereo Audio Connection Cable with 3.5mm stereo plugs
- 1 x User Manual

LOCATION OF CONTROLS

MAIN UNIT

TOP VIEW

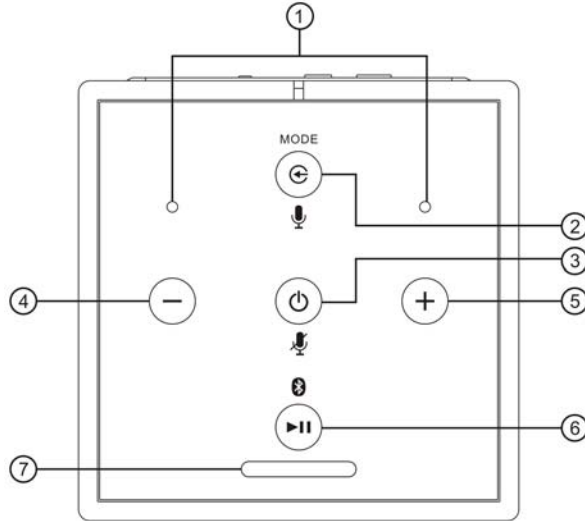

Controls	Press & hold	Tap
1. Microphone	---	---
2. Mode / Tap to talk Button	Changes the speaker mode (Bluetooth / Line-in / Wi-Fi)	Activates the Mic without having to say Alexa first
3. Power On / Standby; Mic ON/OFF Button	Turns the unit On/ Off	Turns the Mic On / Off
4. Volume - Button	Quickly decreases the volume level	Steps down through the volume levels
5. Volume + Button	Quickly increases the volume level	Steps up through the volume levels
6. Play/ Pause/ Pair	Enters pairing mode when in Bluetooth mode	Play/ Pause for Wi-Fi/ Bluetooth playback
7. Mode indicator LED	---	---

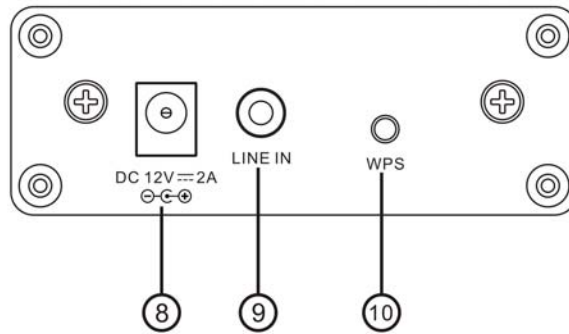

Back View



Controls	Press & hold	Tap
8. DC IN Jack	---	---
9. LINE-IN Jack	---	---
10. WPS Button	In Wi-Fi mode, press and hold this button for 5 – 6 seconds then release it. The unit will reset the Wi-Fi settings back to the factory default settings and then reset automatically.	In Wi-Fi mode, tap this button once to link the speaker to your Wi-Fi network using the JENSEN WI-FI AUDIO APP.

GETTING STARTED

CONNECTING THE AC POWER

This unit operates using the included AC adaptor with 12V  2A (center-positive ) output, and is compatible with standard 120V~ 60Hz AC household power

Insert the the DC Plug of the AC Adaptor into the DC IN jack on the back of the unit. Plug the AC Adaptor into a standard 120V~ 60Hz AC wall outlet.

INITIALIZATION

The unit will initialize when first plugged in. The initialization process could take up to 60 seconds to complete, so please wait for this process to finish before proceeding. The LED will be flashing White, you will hear a voice prompt of "Ready for a set up" when the initialization is completed. The unit is now in setup Mode.

NOTE:

- 1.) The initialization process may take up to 60 seconds or longer when first connected. This process is normal and only occurs when first plugged in.
- 2.) If the unit has been setup to connect your Wi-Fi network successfully, the LED will be solid White after it's connected. The unit is now in Wi-Fi mode.

There is a multicolor LED indicator on the top panel. The operation mode is indicated by different color of the LED. The type of activity is indicated by whether the LED is on or flashing.

Speaker Mode	Mode LED color	Flashing	Solid ON
Bluetooth	Turquoise	Disconnected	Connected
Wi-Fi	Blue	Alexa thinking	Alexa listening
	Blue & White	Alexa talking	---
	White	Wi-Fi disconnected	Wi-Fi Connected
Line-in	Green	---	Line in mode
All modes	Red	---	Mic Off
All modes (When you say Alexa or Tap to talk)	Yellow	---	No network connection/ Not signed into Amazon account

CONNECTING THE JSB-550 TO A WI-FI NETWORK

IMPORTANT:

- The JSB-550 only operates on a single band (2.4 GHz) Wi-Fi network. If you are having problems connecting the JSB-550 to your network, check your router settings and make sure the 2.4 GHz signal is turned and you are accessing the correct band before proceeding.
 - Before you begin, make sure you have an Amazon account. You need an Amazon account in order to use the Alexa voice control. Go to "www.Amazon.com" to register.
1. Download the JENSEN WI-FI AUDIO APP to your phone from Play store for Android phone and App store for iOS device.



Android App



iOS App

2. Turn On the unit, you will hear the voice indication for the unit in Wi-Fi mode and the Mode LED will flashing White. Press and hold the MODE button repeatedly to select Wi-Fi mode if necessary.
3. Run the JENSEN WI-FI AUDIO APP and follow on screen guide to setup the network.
4. Touch the "Wi-Fi Setup Wizard" button on your smartphone screen to add the first speaker to your network.

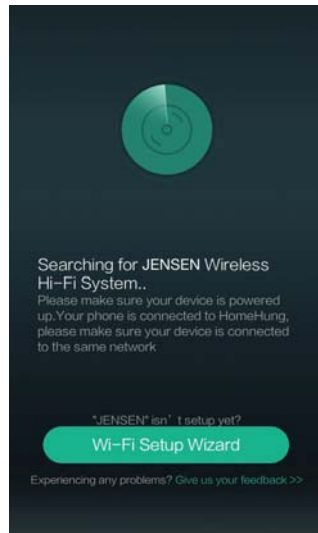

5. Select your Wi-Fi network from the list and touch the "next" button. Type the password of your Wi-Fi network when prompted.

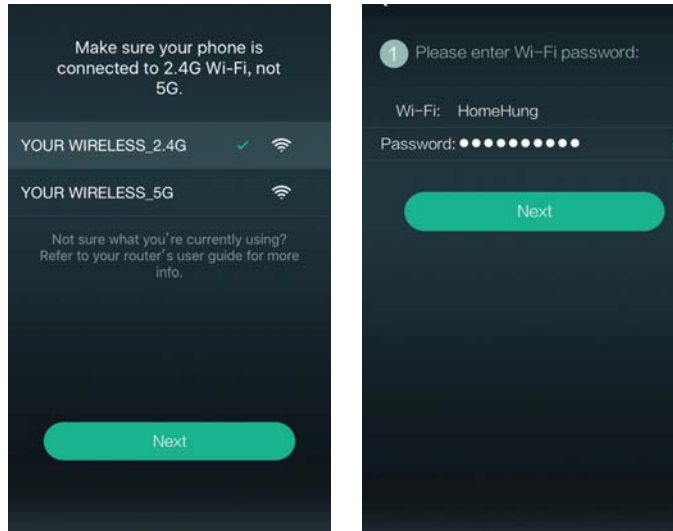

6. Press the WPS button on the back of the JSB-550 and touch the "next" button on your smartphone screen.

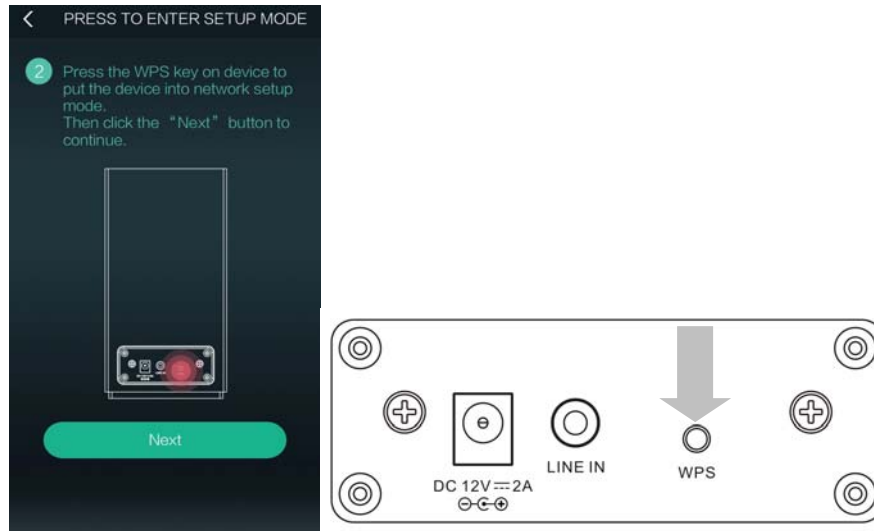

7. The JENSEN WI-FI AUDIO APP will search for the JSB-550 and automatically add it to your network.

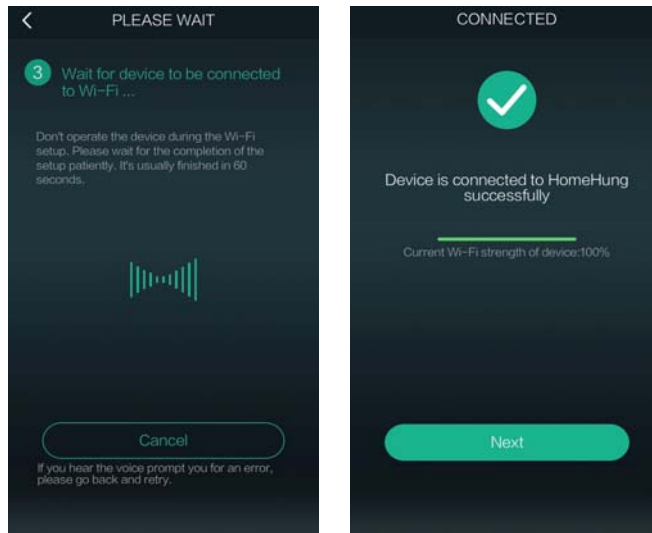

8. After the JSB-550 is connected to Wi-Fi, touch the "Next" button to select the speaker's name from the list or set a custom one.

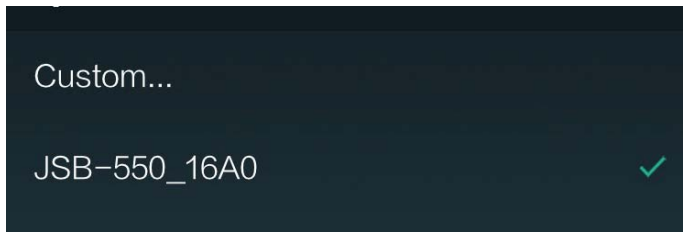

9. Sign in your Amazon account and set the Amazon language. Once you finish, you can enjoy the JSB-550 using the Alexa voice control features.

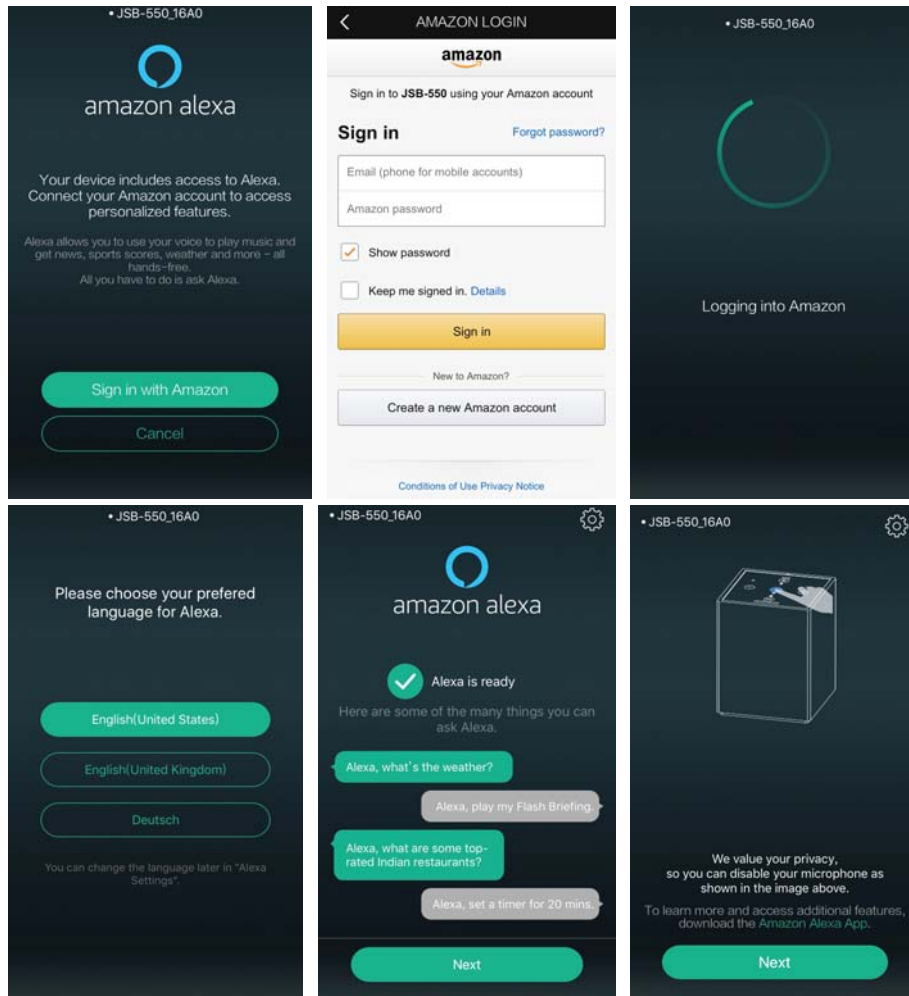

Notes:

To play music with Alexa, you also need to register the Amazon Prime Music service or upload the music on Amazon sever library.

10. To add more speakers, touch the “+” icon in the top right corner of your smartphone screen and repeat the above steps.

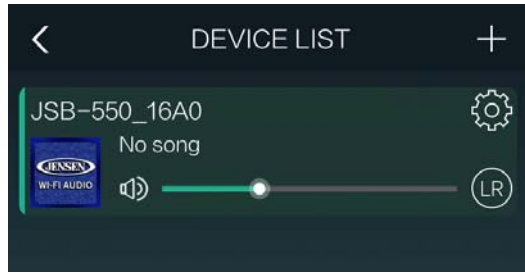

Reconnecting the JSB-550 to a Wi-Fi network

1. Turn the JSB-550 on, and select Wi-Fi mode. Tap the WPS button on the back of JSB-550 and you will hear “Connecting to your network” from the speaker.
2. Follow steps 3-8 above.

Resetting the JSB-550 Wi-Fi to Factory data reset

1. Turn on the unit and select Wi-Fi mode. Press and hold the WPS button for 5 – 6 seconds and release the button. You will hear “Factory data reset” from the speaker.
2. Wait for unit to restart, then unplug and reconnect the power and unit would restart again, you will hear the voice prompt for ready to set up.
3. Follow steps 3-8 above.

Note:

Always set-up the Wi-Fi connection with the JSB-550 ON and in Wi-Fi mode.

Do not press the WPS button unless you are instructed to during one of the steps above. This may cause Wi-Fi setup error.

USING THE ALEXA VOICE CONTROL

When asking Alexa questions always say "Alexa" first or tap the "Tap to talk" button on the top panel, the Mode LED turns Blue, and this indicates that Alexa is listening.

Play music from Amazon Music, TuneIn and many more apps/ services just by using voice commands. Example: Say "Alexa.... Play music from TuneIn Radio."

Answers questions, such as time and date, find out sports scores and schedules, read Audible audio books, listen to news, traffic and weather reports, find info on local businesses, consult Wikipedia Example: Say "Alexa.... What time is it?"

Take notes, prepare shopping lists, shop at Amazon.

Note: To enable voice control, you will need an account to play music from Amazon Music and some other services. Now, simply say "Alexa" or tap the Tap to talk button, when Mode LED turns to solid blue,

Things to try:

- Hello
- Who are you
- What is the weather today
- Who is Michael Jackson
- What is the time now
- Wikipedia: George Washington
- Tell me a joke
- Play iHeart Radio
- Set Alarm..
- Set Timer ..
- Play a song (need Amazon Prime Music service registered or have songs at Amazon Music Library)

For more examples, go to "Thing to Try" in the Alexa App.

INTERACTING WITH THE AMAZON ALEXA APP

You can download the Amazon Alexa app from Play Store or Apple Store.

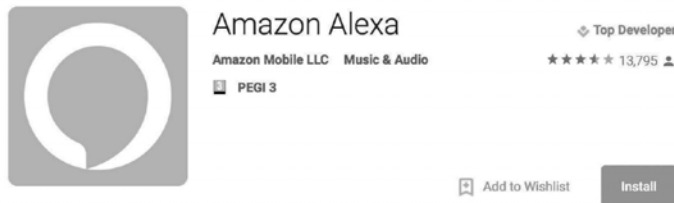

Please login your Amazon account. In the settings you can use the menus to connect to apps like Amazon Music, Live Radio, TuneIn and others as well as reviewing your Alexa history and check your timer & Alarm settings.

GROUP AND UNGROUP THE SPEAKERS

GROUPING THE SPEAKERS

Open the JENSEN WI-FI AUDIO APP, in the list of the available speakers, grab and drag one speaker and drop it over another speaker. In this way, this speaker (slave) becomes part of a group and Master speaker's music is also played through all the Slave speakers.



Mode LED indicator colors when speakers are grouped

Speaker Mode	Mode LED Color
Master Speaker (BT)	Turquoise
Master Speaker (Line in)	Green
Master Speaker (Wi-Fi)	White
Slave Speaker	Red

Note: Only the Master speaker in the group has Alexa Voice feature.

UNGROUP THE SPEAKERS

If you want to ungroup, just grab and drag the slave speaker below the middle line. Slave speaker becomes Master speaker and can play different music



Note:

- You can make one or more speaker groups.
- You can have more than one Slave speakers under the same Master
- In a Group, even if the source is Line in/Bluetooth, you can listen to Slave speakers playing the same song as Master speaker (Redirect feature)
- You can simultaneously control the volume of all the speakers in a group by Volume buttons of your device
- For a group configuration, choose which speaker can play Left (L), Right (R) or Left/Right (L/R), by touching the relevant icon.
- Master Speaker Mode LED – Shows current operation Mode color
- Slave Speaker LED – Shows RED color to indicate it is a Slave, voice control and mode button are disabled.

PLAYBACK MUSIC ON THE SPEAKERS

JENSEN WI-FI AUDIO APP screen,

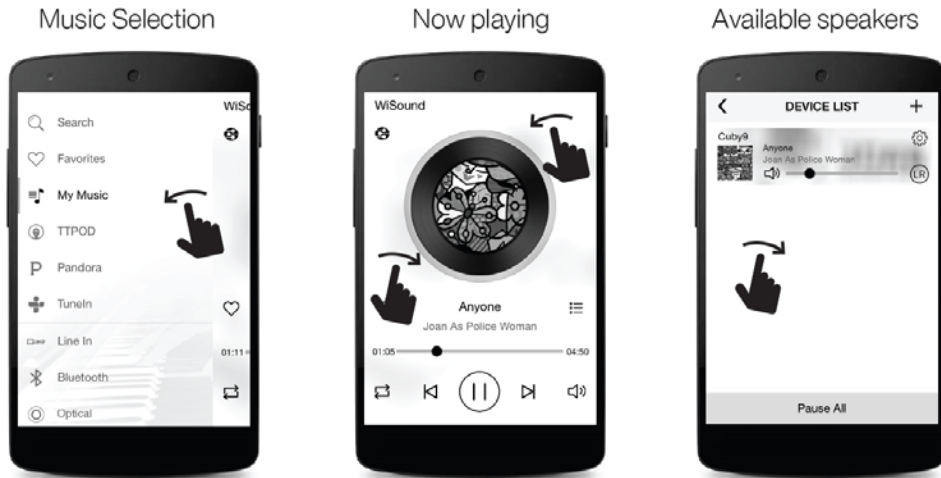

- Select your local songs through MY MUSIC.
- Access Web Radio through TuneIn.
- Change Input through Bluetooth or Line-In.
- Search for online songs through Search.
- Access your Favorite songs through Favorites.
- Access Web services by touching the corresponding icons.

PRESET WEB RADIO STATIONS

To assign web radio stations to preset button (up to 5 stations can be assigned), open the main menu of the JENSEN WI-FI AUDIO APP.

1. Select **TuneIn**



2. Browse your favorite **station**



3. Press the **small icon** next to the **web radio station**



4. Select the required **preset number**





To access the preset web radio stations, go to the "DEVICE LIST" page of the JENSEN WI-FI AUDIO APP, touch the setup icon.



Select "PRESET CONTENT" from menu, the stored preset list will show for you to select for playback.

BLUETOOTH OPERATION

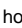
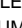
PAIRING (LINKING) A BLUETOOTH ENABLED CELL PHONE OR OTHER BLUETOOTH ENABLED DEVICE to the JSB-550

1. With the JSB-550 in power ON Mode, press and hold the MODE button to select Bluetooth mode. The Mode Indicator LED turns Turquoise and will be flashing. The JSB-550 is now ready to pair (link) with your Bluetooth device.
2. Turn on the Bluetooth feature of your cell phone and turn down the volume to avoid sudden loud sound bursts from the speaker. Enable the search or scan feature to find the JSB-550.
Note: If you have more than one JSB-550 within range, make sure you are connecting to the appropriate speaker.
3. Select "JSB-550" from the device list when it appears on your device screen. If required, enter the pass code "0000" to pair (link) the JSB-550 with your cell phone.
4. After successfully pairing (linking) your cell phone with the JSB-550, the Mode Indicator LED stops flashing and remains lit Turquoise. You can now play music from your cell phone or Bluetooth device wirelessly to the JSB-550.
Note: If you want to connect the JSB-550 to another cell phone after pairing successfully, then you need to turn off the Bluetooth on the paired cell phone first if it is in range before going through the above steps. Otherwise, the JSB-550 will automatically reconnect to the previously linked cell phone or device. Then press and hold the Bluetooth  /PLAY/PAUSE  button to put the JSB-550 into Bluetooth pairing mode, the LED Indicator will be flashing Turquoise.
5. Press the VOLUME +/- button to adjust the volume level.
6. Press the PLAY/PAUSE  button to pause or resume playback.
7. To turn off the JSB-550 Bluetooth, press and hold the  button on main unit for 2 seconds to turn the unit to standby mode. Mode Indicator LED turns off. Don't forget to also turn off the Bluetooth feature on your cell phone or Bluetooth device.

Notes:

- 1.) Refer to manual of your cell phone or other Bluetooth enabled device for Bluetooth operation, since it may vary from model to model.
- 2.) If your Bluetooth enabled device does not support A2DP, it will not play the music through the speaker, even after it's paired (linked).
- 3.) If you are pairing (linking) your computer to the JSB-550 using Bluetooth, you may need to set the JSB-550 as your computer's default sound device.

Note: In power on mode, If no sound playback or paused by user for 15 minutes, unit will turn into standby mode automatically for power saving.

Re-linking to a cell phone or Bluetooth device

If your cell phone or Bluetooth device is already paired with the JSB-550, but became unlinked at some point, even with both Bluetooth devices turned on. You can re-link them by:

1. Press and hold the  /PLAY/PAUSE button to re-link your cell phone. The Mode Indicator LED will turn Turquoise and flash while linking.
2. Select the JSB-550 from the devices list on your cell phone for linking. The Mode Indicator LED stops flashing and remains lit Turquoise if the JSB-550 and your cell phone have been re-linked successfully.
3. You can also re-link the JSB-550 by using Bluetooth operation of your cell phone. Please refer to operation manual of your cell phone for more information.

LINE-IN OPERATION

This unit provides a LINE IN jack for connecting external audio devices like MP3 players, CD players and listen to them through the speakers of this unit.

1. Use an audio cable (included) with one 3.5 mm stereo plug on each end of the cable.
2. To select auxiliary audio input, plug one end into the Aux IN jack on the back of main unit.
3. Plug the other end of the cable into the Line-out Jack or Headphone Jack of your external audio device.
4. Turn on the external audio device and the main unit.
5. Press and hold the MODE button to select Line-in mode, Mode Indicator LED turns Green.
6. The volume level can now be controlled through the main unit. Operate all other functions on the auxiliary device as usual.

NOTE:

- ♦ If you connect this unit to the Line-Out Jack of your external device then you only need to adjust the volume control of this unit. If you connected the Headphone Jack of your external device then you may need to adjust both the volume control of your external device and the volume control of this unit to find the most desirable volume setting.
- ♦ In power on mode, If no sound playback or paused by user for 15 minutes, unit will turn into standby mode automatically for power saving.
- ♦ Press and hold the POWER  button for 2 seconds to turning off the unit when you finish listening. Don't forget to switch off the power of your external device as well.

POWER SAVING

To save power, the speaker will automatically turn off if no sound has played through it for 15 minutes.

RESETTING THE JSB-550

In case of malfunction due to electrostatic discharge, the apparatus has to be reset by disconnecting it from mains supply. Unplug the AC adaptor from main power, wait at least for 60 seconds before reconnect the AC adaptor power.

CARE AND MAINTENANCE

1. Do not subject the unit to excessive force, shock, dust or extreme temperature.
2. Do not tamper the internal components of the unit.
3. Clean your unit with a dry cloth. Solvent or detergent should never be used.
4. Avoid leaving your unit in direct sunlight or in hot, humid or dusty places.
5. Keep your unit away from heating appliances and sources of electrical noise such as fluorescent lamps or motors.

CLEANING THE UNIT

- ♦ To prevent fire or shock hazard, disconnect your unit from the AC power source when cleaning.
- ♦ The finish on the unit may be cleaned with a dust cloth and cared for as other furniture, Use caution when cleaning and wiping the plastic parts.
- ♦ If the cabinet becomes dusty wipe it with a soft dry dust cloth. Do not use any wax or polish sprays on the cabinet.
- ♦ If the top panel becomes dirty or smudged with fingerprints it may be cleaned with a soft cloth slightly dampened with a mild soap and water solution. Never use abrasive cloths or polishes, as these will damage the finish of your unit.

CAUTION: Never allow any water or other liquids to get inside the unit while cleaning.

Note: This unit is not magnetically shielded and may cause color distortion on the screen of some TVs or video monitors. To avoid this, you may need to move the unit further away from the TV or monitor if unnatural color shifts or image distortion occurs.

TROUBLESHOOTING GUIDE

Should you experience difficulties in the use of this player please refer to the following chart or call 1-800-777-5331 for Product Service and Support.

Symptom	Possible Problem	Solution
The unit does not respond (no power)	The unit is disconnected from the AC outlet.	Reconnect to the AC outlet.
	The AC outlet has not power.	Try the unit on another outlet.
Unit is ON but there is low or no volume	The volume control has been turned all the way down.	Turn the Volume control to a higher output.
Cannot connect to the Wi-Fi network	Speaker is off or not in Wi-Fi mode.	Turn on speaker and select Wi-Fi mode.
	Wi-Fi network is incorrect or malfunction.	Select correct Wi-Fi network. Try your other device to ensure your WiFi network is working properly.
	App is not installed properly	Uninstall then reinstall the app, power the speaker Off, then On, and restart setup by use WPS button.
No Sound	Alexa speaker is not in same WiFi network of your smartphone.	Use the same Wi-Fi network for speaker & your smartphone.
	Speaker is not set up for Amazon Alexa.	Set up speaker by following the set up steps in the manual.
	You have not select casting to speaker.	Select speaker in your smartphone screen.
	Bluetooth speaker is not linked with the cell phone.	Go through "Bluetooth Operations" process to link the speakers.
	Speaker placement out of range.	Relocate the speaker within Bluetooth operating range
Alexa voice control not function.	JSB-550 is not connected to your Wi-Fi network.	Use the JENSEN WI-FI AUDIO APP app to connect JSB-550 to your Wi-Fi network.
	You have not logged into your Amazon Alexa account.	Create and login your Amazon Alexa account.
	JSB-550 microphone is disabled	Tap the POWER  button to enable the microphone.
Sound is distorted	Volume level is set too high.	Decrease the volume.
	Sound source is distorted.	If the external device original sound source is of poor quality, distortion and noise are easily noticed with high-power speakers. Try a different audio source such as a music CD. If you are using an external sound source like older generation of iPod, try reducing the output volume on the device itself. Also try turning bass boost OFF or change the EQ setting.
Unit gets warm after extended play at high volume	This is normal.	Turn the unit off for a period of time or lower volume.

SPECIFICATION

Power requirement:

Main Unit AC-DC Adaptor DC 12V --- 2 A $\text{⊖} \text{---} \text{⊕}$

Wi-Fi 802.11a/b/g/n compliant
Single band Wi-Fi antenna supporting 2.4 GHz

Bluetooth Password: 0000
WiFi Password; JENSENJSB-550

The WiFi password can be used if you use a PC, a tablet or mobile device to log in an set up the speaker though the IP address (the IP address can be found on the speaker info page accessed via the settings in the device list in the app)



At Spectra, environmental and social responsibility is a core value of our business. We are dedicated to continuous implementation of responsible initiatives with an aim to conserve and maintain the environment through responsible recycling.

Please visit us at <http://www.spectraintl.com/green.htm> for more information on Spectra's green initiatives or to find a recycler in your area.

The *Bluetooth*® word mark and logos are registered trademarks owned by Bluetooth SIG, Inc. and any use of such marks by Spectra Merchandising Intl, Inc. is under license. Other trademarks and trade names are those of their respective owners.

Amazon, Alexa, and all related logos and motion marks are trademarks of Amazon.com, Inc. or its affiliates.

Amazon Terms & Polices

The JSB-550 is an Alexa- enabled device. Before using this speaker, please read all rules and policies for Alexa, including the Amazon.com Privacy Notice at www.amazon.com/privacy and the terms found in the Alexa App in Help > legal & Compliance. These terms, notices, and policies are, collectively, the "Agreements" By using Alexa, you agree to be bound by the Agreements.

90 DAY LIMITED WARRANTY AND SERVICE VALID IN THE U.S.A. ONLY

SPECTRA MERCHANDISING INTERNATIONAL, INC. warrants this unit to be free from defective materials or factory workmanship for a period of 90 days from the date of original customer purchase and provided the product is utilized within the U.S.A. This warranty is not assignable or transferable. Our obligation under this warranty is the repair or replacement of the defective unit or any part thereof, except batteries, when it is returned to the SPECTRA Service Department, accompanied by proof of the date of original consumer purchase, such as a duplicate copy of a sales receipt.

You must pay all shipping charges required to ship the product to SPECTRA for warranty service. If the product is repaired or replaced under warranty, the return charges will be at SPECTRA's expense. There are no other express warranties other than those stated herein.

This warranty is valid only in accordance with the conditions set forth below:

1. The warranty applies to the SPECTRA product only while:
 - a. It remains in the possession of the original purchaser and proof of purchase is demonstrated.
 - b. It has not been subjected to accident, misuse, abuse, improper service, usage outside the descriptions and warnings covered within the user manual or non-SPECTRA approved modifications.
 - c. Claims are made within the warranty period.
2. This warranty does not cover damage or equipment failure caused by electrical wiring not in compliance with electrical codes or SPECTRA user manual specifications, or failure to provide reasonable care and necessary maintenance as outlined in the user manual.
3. Warranty of all SPECTRA products applies to residential use only and is void when products are used in a nonresidential environment or installed outside the United States.

This warranty gives you specific legal rights, and you may also have other rights which vary from state to state. TO OBTAIN SERVICE please remove all batteries (if any) and pack the unit carefully and send it freight prepaid to SPECTRA at the address shown below. IF THE UNIT IS RETURNED WITHIN THE WARRANTY PERIOD shown above, please include a proof of purchase (dated cash register receipt) so that we may establish your eligibility for warranty service and repair of the unit without cost. Also include a note with a description explaining how the unit is defective. A customer service representative may need to contact you regarding the status of your repair, so please include your name, address, phone number and email address to expedite the process.

IF THE UNIT IS OUTSIDE THE WARRANTY PERIOD, please include a check for **\$65.00** to cover the cost of repair, handling and return postage. All out of warranty returns must be sent prepaid.

It is recommended that you contact SPECTRA first at 1-800-777-5331 or by email at custserv@spectraintl.com for updated information on the unit requiring service. In some cases the model you have may be discontinued, and SPECTRA reserves the right to offer alternative options for repair or replacement.

SPECTRA MERCHANDISING INTERNATIONAL, INC.
4230 North Normandy Avenue,
Chicago, IL 60634, USA.
1-800-777-5331

To register your product, visit the link on the website below to enter your information.
<http://www.spectraintl.com/wform.htm>

0917

Printed in China