



TRIMLINE PHONE



KT2008 USER GUIDE

PLEASE READ THIS USER GUIDE COMPLETELY
BEFORE OPERATING THIS UNIT AND RETAIN THIS BOOKLET
FOR FUTURE REFERENCE.

IMPORTANT SAFETY INSTRUCTIONS



This symbol is to alert you the important operating or servicing instructions that may appear in your owner's manual. Always follow basic safety precautions when using this product to reduce the risk of injury, fire or electric shock.

When using your telephone equipment, basic safety precautions should always be followed to reduce the risk of fire, electric shock and injury to persons, including the following:

1. Read and understand all instructions.
2. Follow all warnings and instructions marked on the product.
3. Unplug this product from the wall outlet before cleaning. Do not use liquid or aerosol cleaners. Use a damp cloth for cleaning.
4. Do not use this product near water, for example, near a bath tub, wash bowl, kitchen sink, or laundry tub, in a wet basement, or near a swimming pool.
5. Do not place this product on an unstable cart, stand, or table. The product may fall, causing serious damage to the product.
6. Slots and openings in the enclosure and the back or bottom are provided for ventilation to prevent overheating. These openings must not be blocked or covered. The openings should never be blocked by placing the product on a bed, sofa, rug, or other similar surface. This product should never be placed near or over a radiator or heat register. This product should not be placed in a built-in installation unless proper ventilation is provided.
7. This product should be operated only from the type of power source indicated on the marking label. If you are not sure of the type of power supply to your home, consult your dealer or local power company.
8. Do not allow anything to rest on the power cord. Do not locate this product where the cord will be abused by persons walking on it.
9. Do not overload wall outlets and extension cords as this can result in the risk of fire or electric shock.
10. Never push objects of any kind into this product through enclosure slots as they may touch voltage points or short out parts that could result in a risk of fire or electric shock, Never spill liquid of any kind on the product.

11. Do not disassemble this product. Take it to a qualified service technician or service center when repair work is required. Opening or removing covers may expose you to voltage or other risks. Incorrect reassembly can cause electric shock when the appliance is subsequently used.
12. Unplug this product from the wall outlet and refer to qualified service personnel under the following conditions:
 - A. When the power supply cord or plug is damaged or frayed.
 - B. If liquid has been spilled into the product.
 - C. If the product has been exposed to rain or water.
 - D. If the product does not operate normally by following the operating instructions. Adjust only those controls that are covered by the operating instructions. Improper adjustment of other controls may result in damage and may require extensive work by a qualified technician to restore the product to normal operation.
 - E. If the product has been dropped or the enclosure has been damaged.
 - F. If the product exhibits a distinct change in performance.
13. Avoid using a telephone (other than a cordless type) during an electrical storm.
There may be a remote risk of electric shock from lightning.
14. Do not use the telephone to report a gas leak in the vicinity of a leak.
15. Never install telephone wiring during a lightning storm.
16. Never install telephone jacks in wet locations unless the jack is specifically designed for wet locations.
17. Never touch uninsulated telephone wires or terminals unless the telephone line has been disconnected at the network interface.
18. Use caution when installing or modifying telephone lines.

SAVE THIS INSTRUCTION

CHANGES IN TELEPHONE COMPANY EQUIPMENT OR FACILITIES

The telephone company may take changes in its communications facilities, equipment, operations or procedures, where such action is reasonably required and proper in its business. Should any such changes render the customer's terminal equipment incompatible with the telephone company facilities, the customer shall be given adequate notice to make modifications to maintain uninterrupted service.

INSTALLATION INSTRUCTION

1. Never install telephone wiring during a lightning storm.
2. Never install telephone jacks in wet locations.
3. Never touch uninsulated telephone wires or terminals unless the telephone line has been disconnected at the network interface.
4. Use caution when installing or modifying telephone lines.

KT2008 - User Guide (English)

CAREFULLY READ AND OBSERVE THE INSTRUCTIONS IN THIS MANUAL.
SAVE THESE INSTRUCTIONS FOR LATER USE

Connecting and Setting Up

Plug one end of the curly handset cord into the socket provided on the end of the handset, and the other end to the socket under the phone.

Connect the straight telephone line cord to the socket under the phone and the other end to the telephone wall outlet.

Wall Mounting

The phone may be mounted on a suitable wall or other vertical surface, by following the procedure below.

Select an area of the wall where you would like to hang your phone and check that there are no pipes or electrical cables buried in the wall in this area. Note – cables to electrical switches and sockets usually run vertically in the wall, therefore do not mount your phone directly above or below an electrical switch or socket unless you are sure that the cables will not be damaged by the fixing screws.

Fix 2 screws into the wall leaving the heads of the screws protruding. The screws should be fixed 100 mm vertically apart.

Align the keyhole slots in the rear of the phone with the heads of the screws and slide the phone slightly downwards so that the heads of the screws locate in the slots. Note – adjust the amount that the screw heads protrude from the wall so that when the phone is finally hung, it lies flat.

Ringer Volume (on the side of the telephone base)

Use to select the ring volume between High, Low and Off

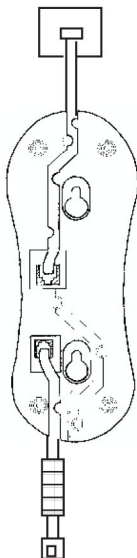

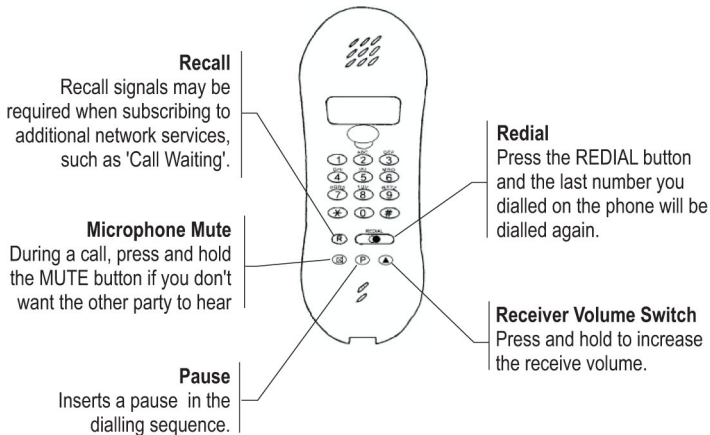

Guarantee - This product is guaranteed against manufacturing defects, for a period of 12 months from the date of purchase.

If this product becomes faulty within the terms of the guarantee, please return it to you supplier with a copy of the purchase invoice.

This guarantee does not cover faults due to: Misuse; negligence; faults on the telephone line; damage due to lightning.

Specification - This product has been manufactured in accordance with the European RTTE directive. It complies with the European Low Voltage Directive 72/23/EEC and the European EMC Directive 89/336/EEC.

En60950 1:2001 (Safety), EN55022:2006 (EMC Emissions), EN55024:1998 (EMC Immunity)

For a copy of the Declaration of Conformity for this product, please write to Lazerbuilt Ltd, 20 Gunnels Wood Park, Stevenage, Herts, SG1 2BH. England

Recycle - Please take care when disposing of this product. At the end of the products life it should be entered into a recycling scheme. It should not be disposed of in normal domestic waste



Made in China for Lazerbuilt Ltd (www.lazerbuilt.co.uk)

